

LANTERNS

214A700 Kerosene Lantern

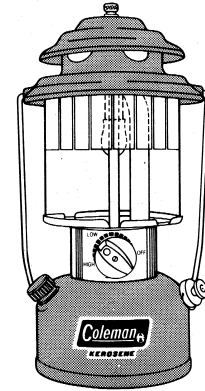

Model 214A700

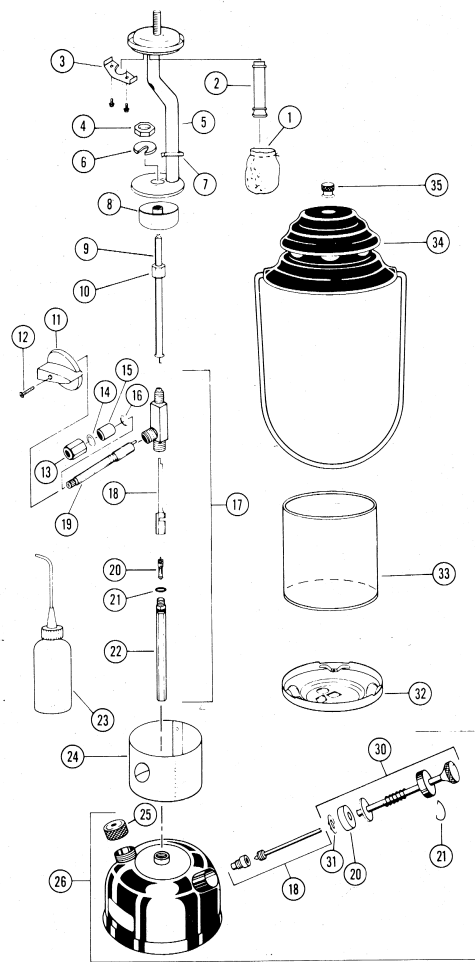

Model 214A700

Model	Color	Diameter	Lantern Height	Fuel Capacity
214A700	Green	5 1/8"	12 1/4"	1.26 Pints

KEY PART NO. DESCRIPTION

①	21A1001	Mantle
②	290-6661	Burner Tube
③	214-1341	Retainer
④	288-1641	Nut
⑤	214A5341	Burner Assy.
⑥	288-1251	U-Clip
⑦	231A3111	Spring Clip
⑧	218-5101	Preheater Cup
⑨	214-5891	Knob
⑩	288-1621	Jamb Nut
⑪	288-5491	Knob
⑫	220C175	Screw
⑬	242B6161	Pack Nut
⑭	1202B1101	Pack Washer . . . Not Available
⑮	118D620	Packing
⑯	413A2131	Pack Washer . . . Not Available
⑰	214-5571	Valve Assy.
⑱	218-3041	Eccentric Block

KEY PART NO. DESCRIPTION

⑲	286A6141	Valve Stem Assy.
⑳	288-3651	Valve Core
㉑	288-1261	O-Ring
㉒	214-5231	Feed Tube Assy.
㉓	201-5511	Alcohol Bottle
㉔	214A5291	Collar
㉕	220C1401	Fuel Cap
㉖	214-5151	Fount Assy.
㉗	200-6381	Check Valve & Stem Assy.
㉘	216-1091	Pump Cup
㉙	530A5071	Pump Clip
㉚	242D5201	Plunger Assy.
㉛	242-1071	Nut
㉜	288-1381	Frame Bottom
㉝	214A0461	Globe
㉞	288-4851	Ventilator & Bail Assy.
㉟	288-4411	Ball Nut