

OPERATING INSTRUCTIONS  
AND  
PARTS LIST FOR  
**J. C. HIGGINS**  
**GASOLINE CAMP LANTERN**

MODEL NUMBER  
710.74000

The above Number is the Model Number of your Gasoline Camp Lantern and will be found stamped into the metal collar between fount and globe. Always mention this Model Number when communicating with us regarding the lantern or when ordering repair parts.

HOW TO ORDER REPAIR PARTS

All parts shown on the following list and illustrated on the parts diagram may be ordered through any Sears Retail or Mail Order Store. In ordering parts by mail from the Mail Order Store which serves the territory in which you live, selling prices will be furnished on request or parts will be shipped at prevailing prices and you will be billed accordingly.

WHEN ORDERING REPAIR PARTS ALWAYS GIVE THE  
FOLLOWING INFORMATION:

1. The part number in this list.
2. The part name in this list.
3. The model number of your Lantern.

This list is valuable. It will assure your being able to obtain proper parts service at all times. We suggest you keep it with other valuable papers.

**SEARS, ROEBUCK AND CO.**



# Burns clear or leaded gasoline

## 1. TO FILL

Make sure valve stem (A) is closed tightly to the right. Remove filler plug (B) and fill fount with gasoline. Use any leaded or clear gasoline. You may fill up to level of filler plug (B) and tighten firmly with fingers.

## 2. AIR PRESSURE

Be sure valve (A) is closed. To open check valve push in on piston (C) and turn it till piston engages in check. Then turn to left one turn. Place thumb over hole (D) in pump knob and pump in 20 to 30 strokes. To close check valve, push (C) in, and turn piston tightly to right or air may leak out of base. See cut on back side.

## 3. TO PUT ON AND BURN OFF MANTLE

Remove cooking top, bail, hood, shield and glass globe. Tie mantle to groove in burner cap (F) with flat side of mantle parallel to generator so that it will not touch the generator. Distribute folds of mantle evenly; cut off surplus asbestos string. Light bottom of mantle evenly with a match; let it burn until nothing but the white ash remains; let mantle cool off a minute before lighting the lantern.

## 4. TO LIGHT

Be sure that:

1. The fount contains fuel.
2. That valve stem (A) is closed tightly.

Now turn gas tip cleaning lever (G) several revolutions; be sure that lever (G) is left pointing downwards.

3. Air pressure has been pumped into the fount.

Open valve stem (A) one-half turn only. You will hear a hissing noise, then your lighted match should be held under the mantle through lighter hole (H). When generator packing is saturated with gasoline you will hear a spitting noise and mantle will light. The light may flicker for a short time before steadying down. **NOW IT IS ESSENTIAL TO OPEN VALVE STEM (A) AS FAR AS POSSIBLE UNTIL IT STOPS.** Pump in more air after lighting. If valve stem (A) is turned out as far as possible too soon, the generator may not be fully generated and lantern will flare up. Partly close stem (A) a little longer for full generation.

## 5. TO TURN OUT LIGHT

Turn valve stem (A) to right until closed. Before going out, it may pop a few times. To stop this, turn cleaning lever (G) up. This also lengthens life of mantle.

## 6. TO REMOVE GENERATOR

Remove cooking top, bail, hood, shields and glass globe. Remove cap screw in center of bottom plate, then lift off plate and burner head assembly. Remove air tube and mixing assembly. Turn tip cleaner lever up. Unscrew generator jam nut, lift up generator and unhook needle from cleaner link. Be careful not to bend or break the needle point when removing or inserting new needle into generator.

## 7. REPLACING GENERATOR

Be sure to avoid damaging generator parts. Be sure to hook cleaning needle correctly in link, and when lowering generator tube, hold tube perfectly vertical so as to avoid damaging the seat. Screw down generator jam nut with thumb and forefinger. Operate cleaning lever (G) and see that needle is coming through orifice. After lantern is reassembled it is best to tighten generator jam nut last to get a good line-up.

## 8. FUEL

Always use clean, fresh leaded or unleaded fuel. Use funnel with strainer No. 7030.

Clean fount at least once a month and drain fount through filler plug opening. This removes old, stale and dirty fuel and heavy sediment which causes rapid carbonization of generator.

## 9. PUMP

Keep pump leather soft with a few drops of oil every month.

## 10. MANTLES

Use only Ready-Lite Mantles – they give more light and are stronger.

## 11. AUTOMATIC TIP CLEANER

When tip cleaner is revolved, the cleaning needle inside the generator is forced up and down through the generator gas tip, cleaning the gas tip orifice. The cleaner lever should be operated when lighted lantern fails to burn bright after valve stem (A) is wide open.

## 12. WHEN PUTTING OUT LANTERN

It is a mistake to put out the lantern through turning cleaning needle lever up – this is not a positive shut-off, the light will go out, but fuel will continue to pass through the generator. For the correct way to put out lantern, see paragraph 5 of Instructions.

## READ CAREFULLY THESE INSTRUCTIONS FOR OPERATING PUMP

**TO OPERATE PUMP**, be sure that tank valves are closed. Push down on pump piston and turn it to engage end of piston in air check. Then turn piston one turn to left, place thumb over hole in pump knob, pump in 20 to 30 strokes of air. Close pump check by turning piston tightly to right.

To open check for pumping in air, engage piston stem A in check slot B and turn to left one turn.

To close check, engage end of piston stem A in check slot B and tighten to right.

After pumping in air, be sure to screw check down tightly or air will leak out, and be sure to push down on piston knob when tightening check.

The pump check assembly is slotted across the top for a screw driver. If necessary to remove the check assembly, be sure to use a screw driver or our S608 wrench with bit 7/16" wide so it extends all the way across the end of the check, or you will damage the check and not be able to remove it.

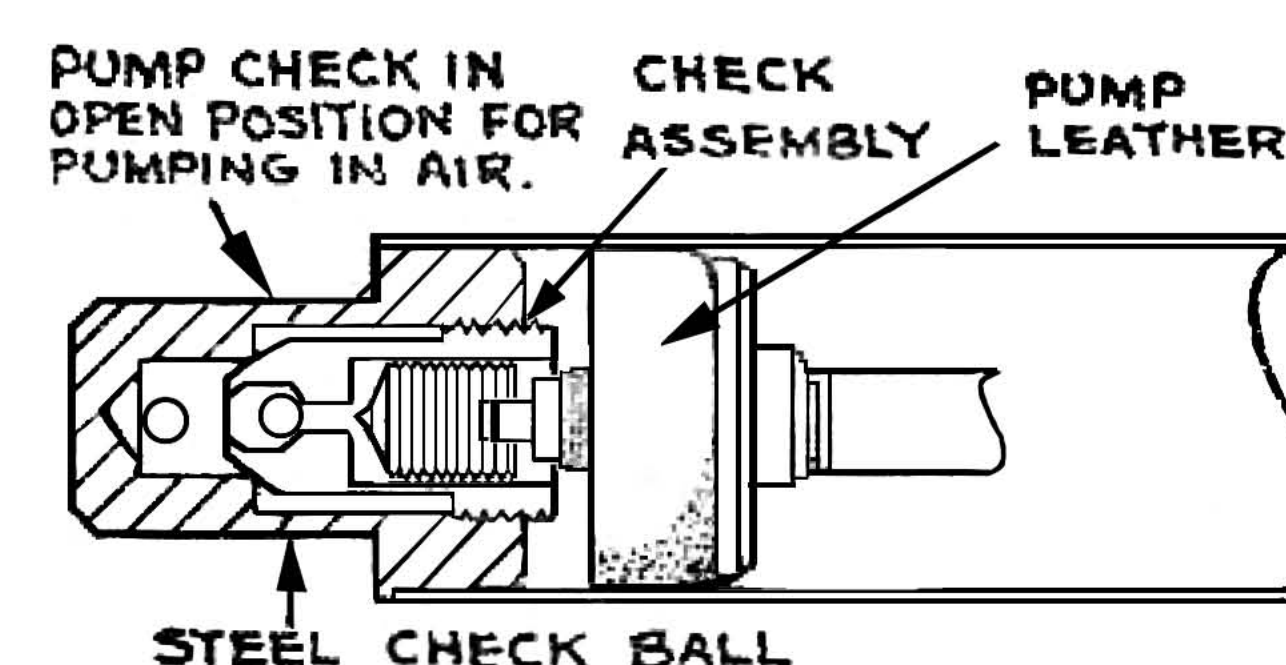
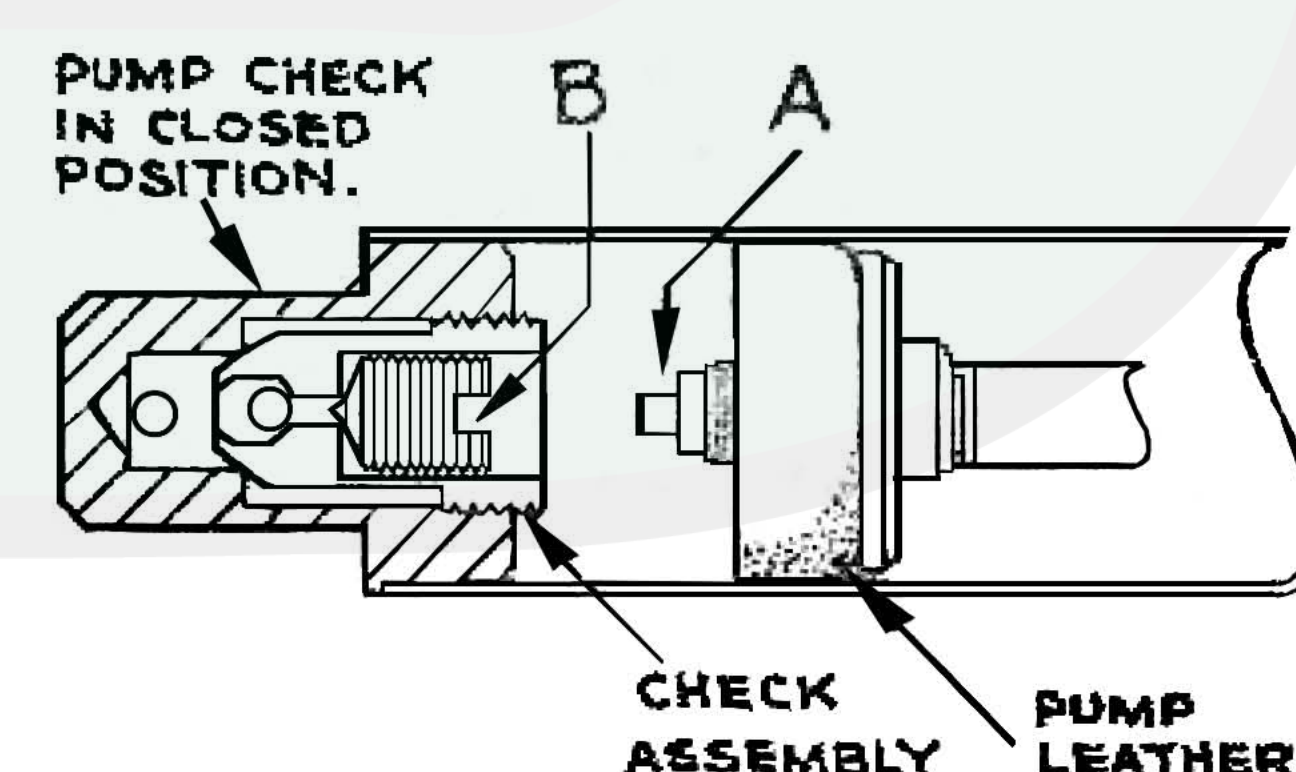



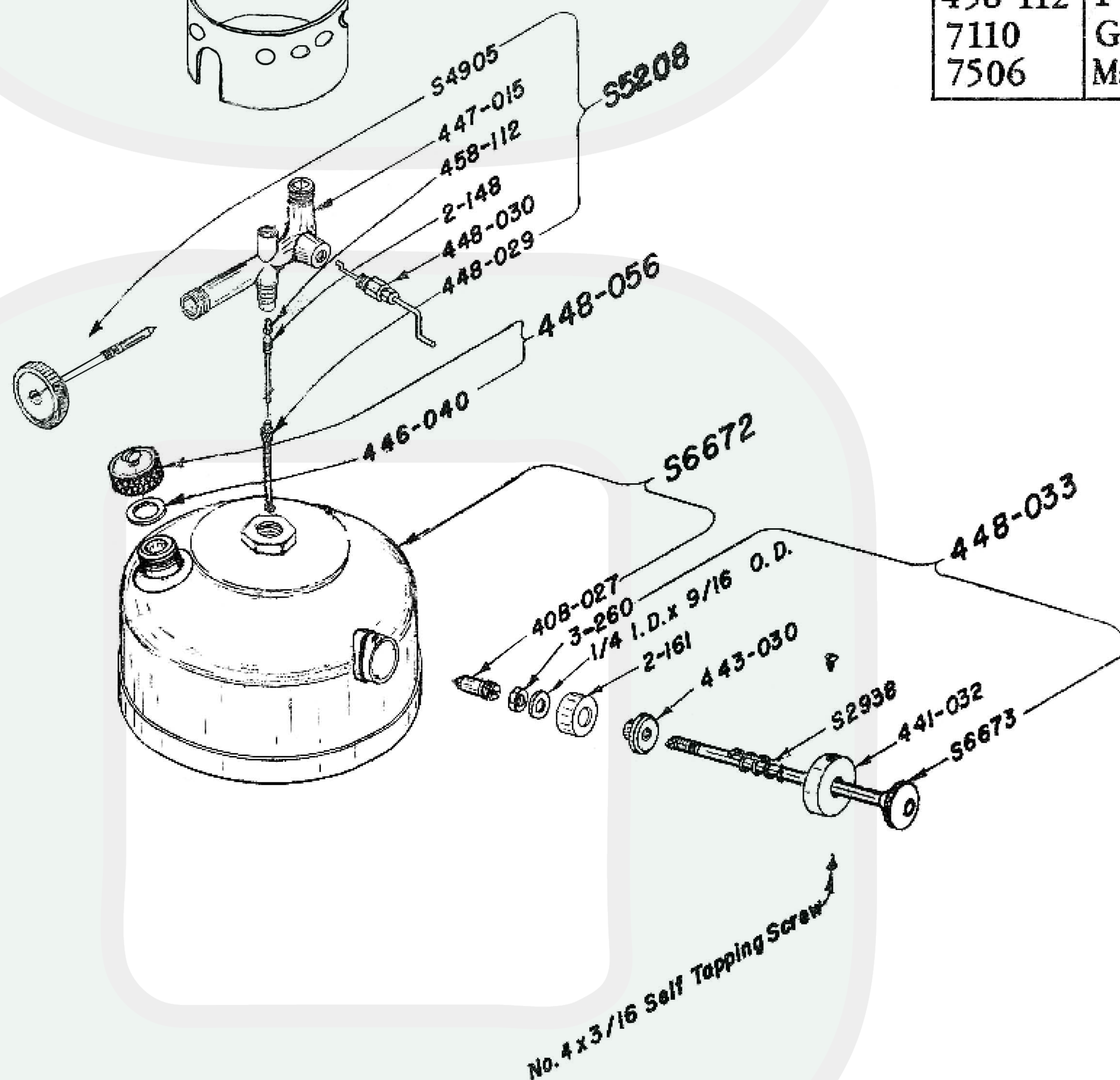
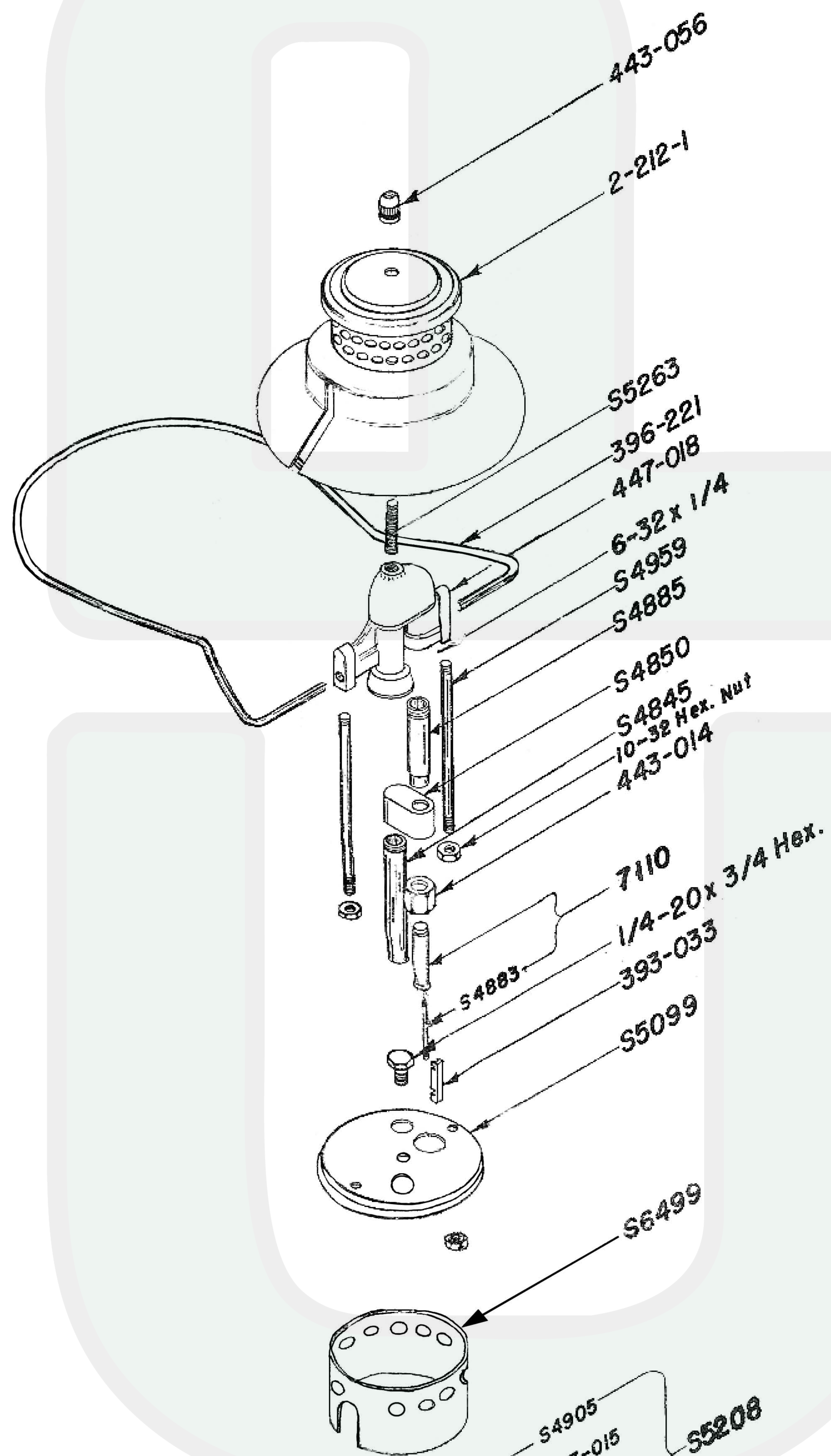

Part No.	Description	Shipping Wght. Lbs. Oz.	Selling Price Each
S2938	Spring	3	
S4845	Air Mix. Tube	3	
S4850	Air Mix. Chamber Assembly	3	
S4883	Needle & Shank Assembly	3	
S4885	Bunsen Tube	3	
S4905	Cutoff Assembly	6	
S4959	Support Rod	3	
S5099	Bottom Plate	14	
S5208	Valve Complete	14	
S5263	Hood Stud	3	
S6499	Collar	14	
S6672	Fount with Check Assembly	2 4	
S6673	Plunger & Handle Assembly	8	
2-148	Spring	3	
2-161	Pump Leather	3	
3-260	Nut	3	
2-212-1	Porcelain Reflector	1 8	
393-033	Eccentric Link	3	
396-221	Bail	14	
408-027	Pump Check Assembly	3	
441-032	Pump Cap	4	
443-014	Jam Nut	3	
443-030	Plunger Disc	3	
443-056	Hood Knob	3	
447-015	Valve Body Forging	10	
448-010	Burner Packing	14	
448-029	Fuel & Air Tube Assembly	3	
448-030	Eccentric Complete	3	
448-033	Pump Piston Assembly	10	
446-040	Filler Plug Gasket	3	
448-056	Filler Plug Valve Cap Assembly	6	
458-112	Fuel Needle Assembly	3	
7110	Generator Assembly	6	
7506	Mantle (not illustrated)	2	