

## REPLACEMENT PARTS

The Model Number will be found on the label located on the front of the stove. Always mention the Model Number when requesting service or repair parts.

All parts listed herein may be ordered from SEARS, ROEBUCK AND COMPANY Retail and Catalog Store.

WHEN ORDERING REPAIR PARTS, ALWAYS GIVE THE FOLLOWING INFORMATION:

1. PART NUMBER
2. PART DESCRIPTION
3. MODEL NUMBER 920.72720
4. NAME OF ITEM Two Burner Folding Cookstove

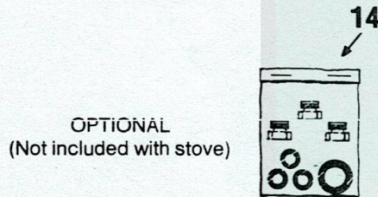

### REPLACEMENT PARTS—MODEL 920.72720

KEY NO.	PART NO.	DESCRIPTION
1	5217-50	REGULATOR ASSEMBLY
2	5217-55	HOSE EXCLUDING REGULATOR
3	5207-21	LARGE BURNER
4	40-0961	GRID - 2 BURNER
5	5217-40	POST & TUBE ASSEMBLY W/SCREW
6	35-1362	RIGHT WINDSCREEN - BEIGE
7	40-0973	ORIFICE .0155
8	5227-52	BOTTOM ASSEMBLY - GREEN
9	40-1820	ADJUSTMENT STEM WITH KNOB
10	40-0988	LATCH GROUP COMPLETE
11	5217-10	MANIFOLD ASSEMBLY WITH NUT
12	35-1363	LEFT WINDSCREEN - BEIGE
13	34-1358	TOP COVER - BEIGE
14	5217-38	REPAIR KIT-orifices, o-rings
15	24-1381	DRIP TRAY - 2 BURNER
16	40-1819	KNOB ONLY

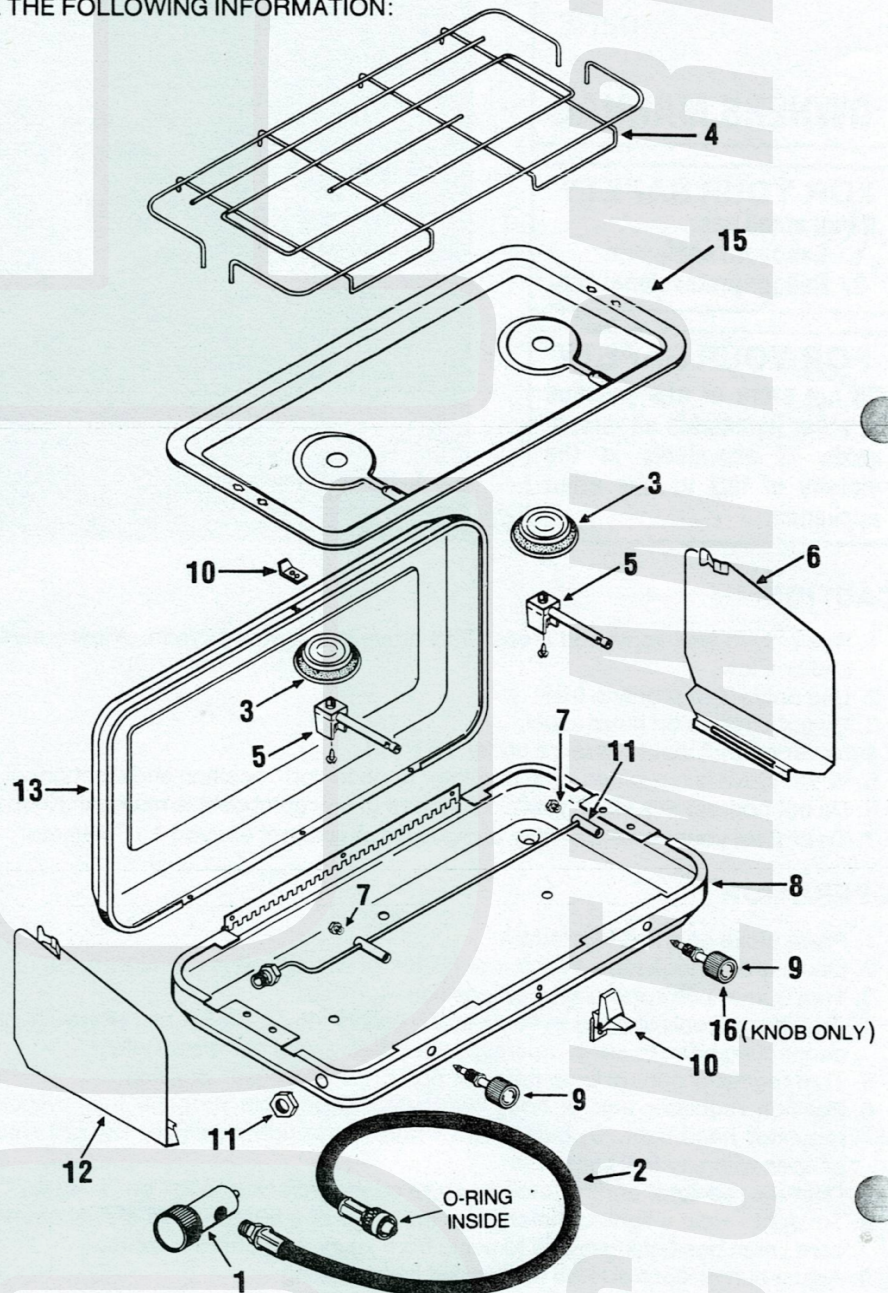

45-0630  
8109

Sears, Roebuck and Co. Chicago, Ill. 60684

Diagram Courtesy of  
Roy Morris